

# BOSCOBEL

HOUSE AND GARDENS



PRIVATE EVENTS



# WELCOME TO BOSCOBEL

Boscobel House and Gardens is a quintessential Hudson Valley icon. Located in Garrison, New York, this magnificent property caters to intimate gatherings and lavish galas, lending a sense of grandeur and distinction to any occasion.

Hosting your event at Boscobel provides unique access to dramatic views of the Hudson River, while helping sustain public programming and one of the finest collections of decorative arts from the Federal period.

Thank you for becoming a part of our history, and for letting us become a part of yours.

Cheers!





## ABOUT BOSCOBEL

Boscobel opened as a nonprofit museum sixty years ago. Built between 1804 and 1808, it was originally the dream house of wealthy Loyalists. By the 1950s, after falling into disrepair, it was demolished. Preservationists saved as many architectural fragments as possible and reassembled them fifteen miles north, where the Neoclassical mansion was restored back to—and even beyond—its original grandeur. Boscobel was saved as a beautiful piece of art.

The Frances Stevens Reese Woodland Trail of Discovery offers hikers a tranquil mile through the forest. The Apple Orchard, Formal Garden, and Herb Garden feature fruit trees, flowers, and plants prized by New Yorkers then and now. The Hudson River School Artists Garden, with sculptures by Greg Wyatt, honors 19th-century painters who celebrated this landscape.

Boscobel embodies, preserves, and shares the beauty of the Hudson River Valley.





A photograph of a garden scene. In the foreground, there is a wooden raised bed filled with lavender plants. Some lavender has white flowers, while others have purple flowers. Behind the lavender is a rustic wooden fence made of horizontal logs. In the background, there are several trees with green leaves. One tree on the right has some green fruit hanging from its branches. The sky is overcast and grey.

**EVENT SPACES**



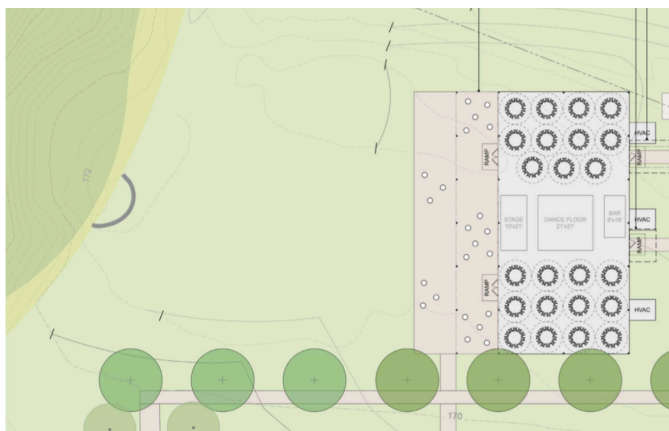
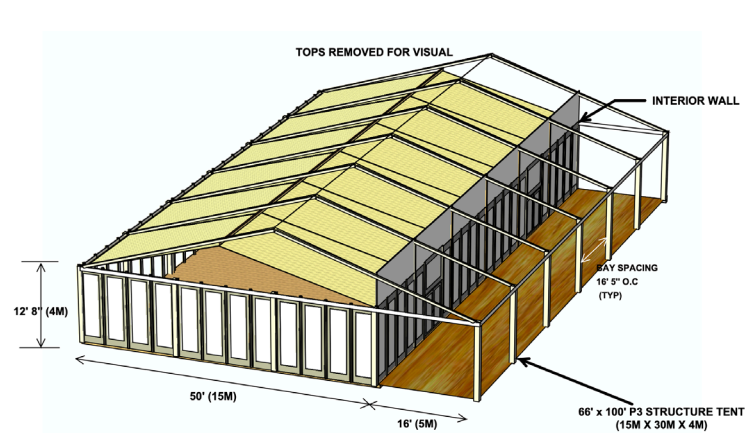

## WEST MEADOW PACKAGE

Enclosed with glass walls, this air-conditioned, 5,000 square foot pavilion has a fixed floor, including a dance floor, stage, and sound/light fixtures. Amplified music is allowed within the West Meadow Pavilion, making it the perfect reception location.

A 12' x 12' preparation tent and ADA compliant luxury portable restrooms are easily accessible. Rental includes the West Meadow with stunning views of the Hudson River, making it the perfect backdrop for any celebration.

### CAPACITY & FEE

6-Hour Event

Up to 250 Seated Banquet-style

\$12,500 + Boscobel Membership

\$1,500 Boscobel Patriot Membership for up to 100 guests

\$5,000 Boscobel Benefactor Membership for 100 or more guests







## THE CARRIAGE HOUSE PACKAGE

Perfect for intimate celebrations, the Carriage House includes the use of the Herb Garden and Lila Wallace Room.

### CAPACITY & FEE

80 Guests

5-Hour Event

\$7,500 + \$1,500 Boscobel Patriot Membership





## THE FORECOURT

Celebrate outdoors in the Boscobel Forecourt. Includes the use of the Lila Wallace Room.

### CAPACITY & FEE

200 Guests

5-Hour Event

\$7,500 + Boscobel Membership

\$1,500 Boscobel Patriot Membership for up to 100 guests

\$5,000 Boscobel Benefactor Membership for 100 or more guests



# THE FORMAL GARDEN

Bordered by English yews, The Formal Garden is laid out in an English wheel pattern and is planted with pollinator-friendly, native species that were popular in early American gardens. Includes the use of the Lila Wallace Room.

## CAPACITY & FEE

100 Guests

5-Hour Event

\$7,500 + \$1,500 Boscobel Patriot Membership







## EXCLUSIVE BOSCOBEL BUYOUT

This full buyout provides you with exclusive all-day access to Boscobel's grounds and event spaces. The Forecourt, Formal Garden, Herb Garden, West Meadow Pavilion, Carriage House, East Terrace, Belvedere, and the Great Lawn are available to you and your guests.

### CAPACITY & FEE

Up to 250 Seated without additional tent  
\$35,000 + \$5,000 Boscobel Benefactor Membership





# ADDITIONAL SPACES



Alessandra Parks Photo

## LILA WALLACE ROOM

### CAPACITY & FEE

40 Guests

3-Hour Event

Daytime Rental: \$2,000

Evening Rental: \$3,500

\$1,500 Boscobel Patriot Membership





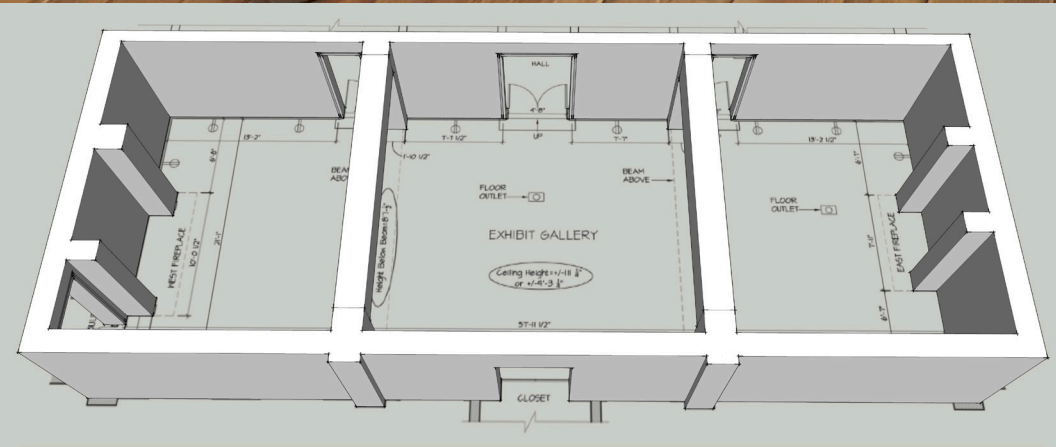

## THE MANSION GALLERY

### CAPACITY & FEE

70 Guests

3-Hour Event

Daytime Rental: \$3,000

Evening Rental: \$4,500

\$1,500 Boscobel Patriot Membership



# HERB GARDEN

## CAPACITY & FEE

50 Guests

3-Hour Event

Daytime Rental: \$1,500

Evening Rental: \$2,500

\$1,500 Boscobel Patriot Membership





# THE BELVEDERE

Overlooking Constitution Marsh toward the U.S. Military Academy at West Point, the view from the Belvedere showcases dramatic views of the Hudson River.

## CAPACITY & FEE

50 Guests

3-Hour Event

Daytime Rental: \$2,000

Evening Rental: \$3,500

\$1,500 Boscobel Patriot Membership







[BOSCOBEL.ORG](http://BOSCOBEL.ORG)